

# Quick mounting



Adjustable foot for supporting bracket TRA-WIK®-ALU and TWL®-ALU



# Dosteba

*Elemente sind  
elements are  
unsere Stärke  
our strength*

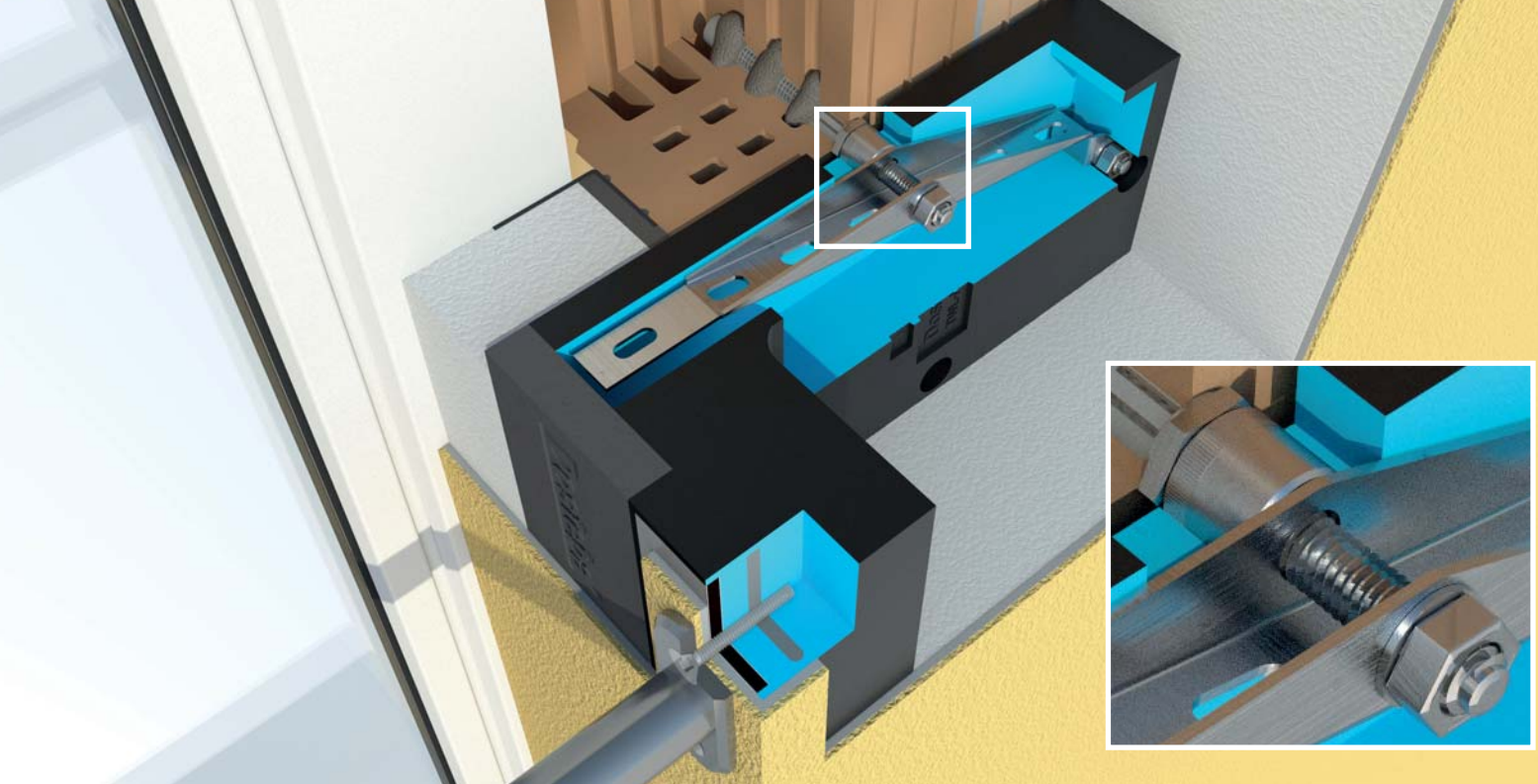

## Adjustable foot for supporting bracket TRA-WIK®-ALU and TWL®-ALU

### The problem

Supporting brackets TRA-WIK®-ALU-RF / -RL and TWL®-ALU-RF / -RL must be friction-locked and pressure-resistant with the substrate, and flush with the insulation plates. Adhesive mortar fulfils this function well, although bonding is not possible for all applications.

### The solution

Adjustable feet allow simple friction-locked and pressure-resistant mounting and alignment of supporting brackets TRA-WIK®-ALU-RF / -RL and TWL®-ALU-RF / -RL – even without adhesive mortar.

### Your benefit

Adjustable feet means that bonding with adhesive mortar is no longer needed, thus saving drying time.

### Your advantages

- ✓ Quick and friction-locked assembly
- ✓ Easy to align
- ✓ No adhesive mortar needed

### The product

Adjustable feet are the ideal accessory for a simple and efficient assembly of supporting brackets TRA-WIK®-ALU-RF / -RL and TWL®-ALU-RF / -RL without adhesive mortar. Use an open-end wrench to set the adjustable feet precisely. The support surface can be enhanced with washers if the substrate has insufficient pressure resistance. Three adjustable feet are needed for each supporting bracket.

#### Adjustable foot

- Diameter external: 20 mm
- Diameter internal: 11 mm
- Adjustment range: 5 - 15 mm
- Recording tool:  $\square 19$

#### Washer

- Material: galvanised, blue
- Dimensions: 10.5 x 30 x 2 mm

#### Open-end wrench, flat

- Wrench size:  $\square 19$

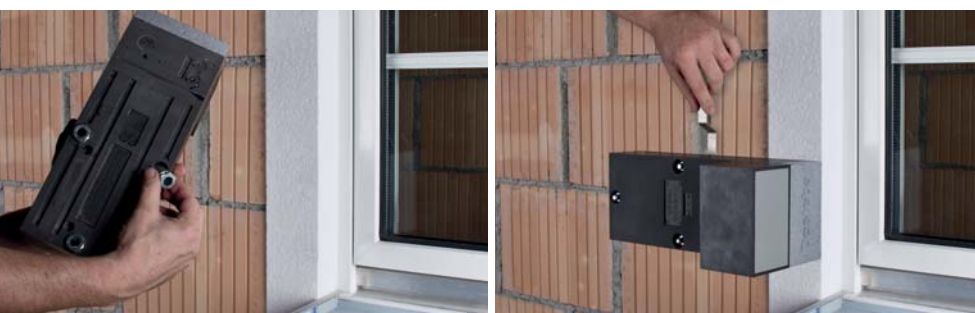

### Dosteba AG

CH-8184 Bachenbülach  
Phone: +41 43 277 66 00

### Dosteba GmbH

D-72770 Reutlingen-Betzingen  
Phone: +49 7121 30177 10