



Always a
cut ahead!

Glow-wire cutting device SPEWE GT127-34



Dosteba

*Werkzeuge sind
Tools are
unsere Stärke
our strength*

SPEWE GT127-34

Convincing details

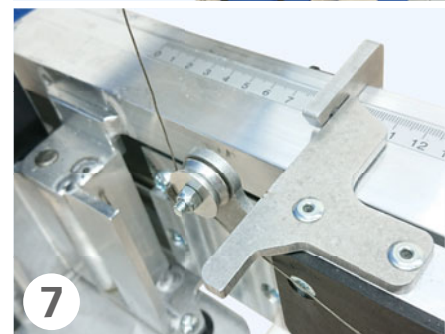
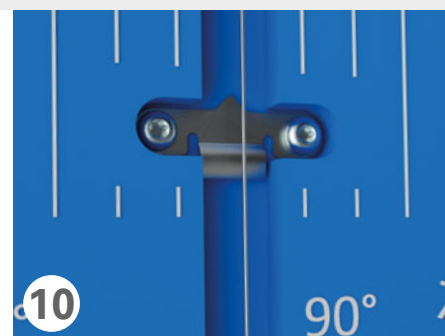
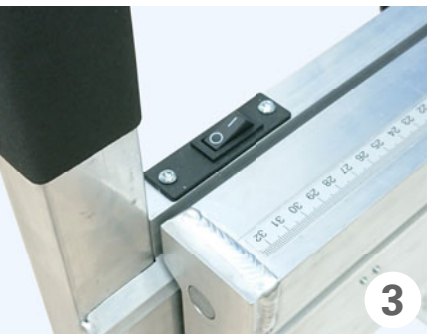
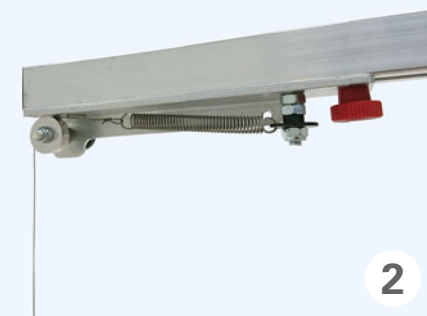

Types of cuts

straight

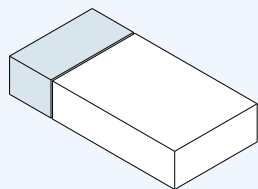

mitre

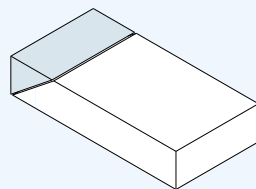

groove

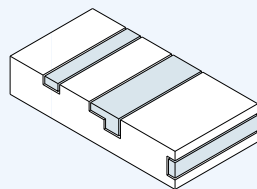

stepped groove

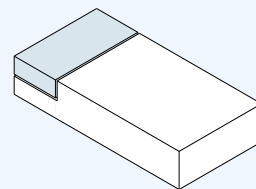

step/rabbet

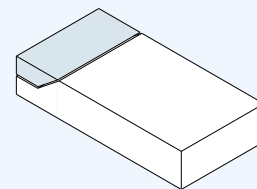

Glow-wire cutting device

Installation positions

11



12

- 1 Telescopic bow cutter length for user-friendly operation on the scaffold
- 2 Infinitely variable incline slide - combined with wire adjustment
- 3 On/off switch for continuous operation
- 4 Spare wire spool with latching mechanism for quick and tool-free wire changing
- 5 Digital display with gauge for repetitive cuts
- 6 Cable reel for winding up the power cable
- 7 Easily accessible wire reel for better cleaning
- 8 High-performance network device for automatic temperature regulation with short or long wires
- 9 Foldable longitudinal stop for repeat cuts
- 10 Burn-in protection plate with integrated tip for exact wire adjustment
- 11 Standing unit with free-standing support
- 12 Unit with free-standing support and corner cutter

step with mitre

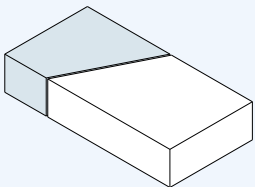

bevel

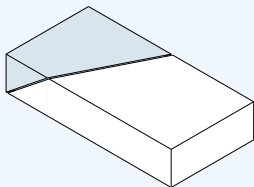

bevel with mitre

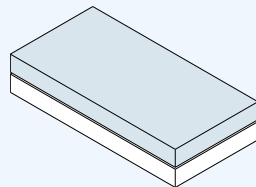

straight cut

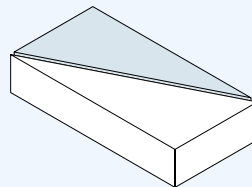

diagonal

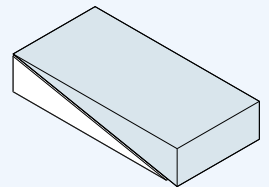

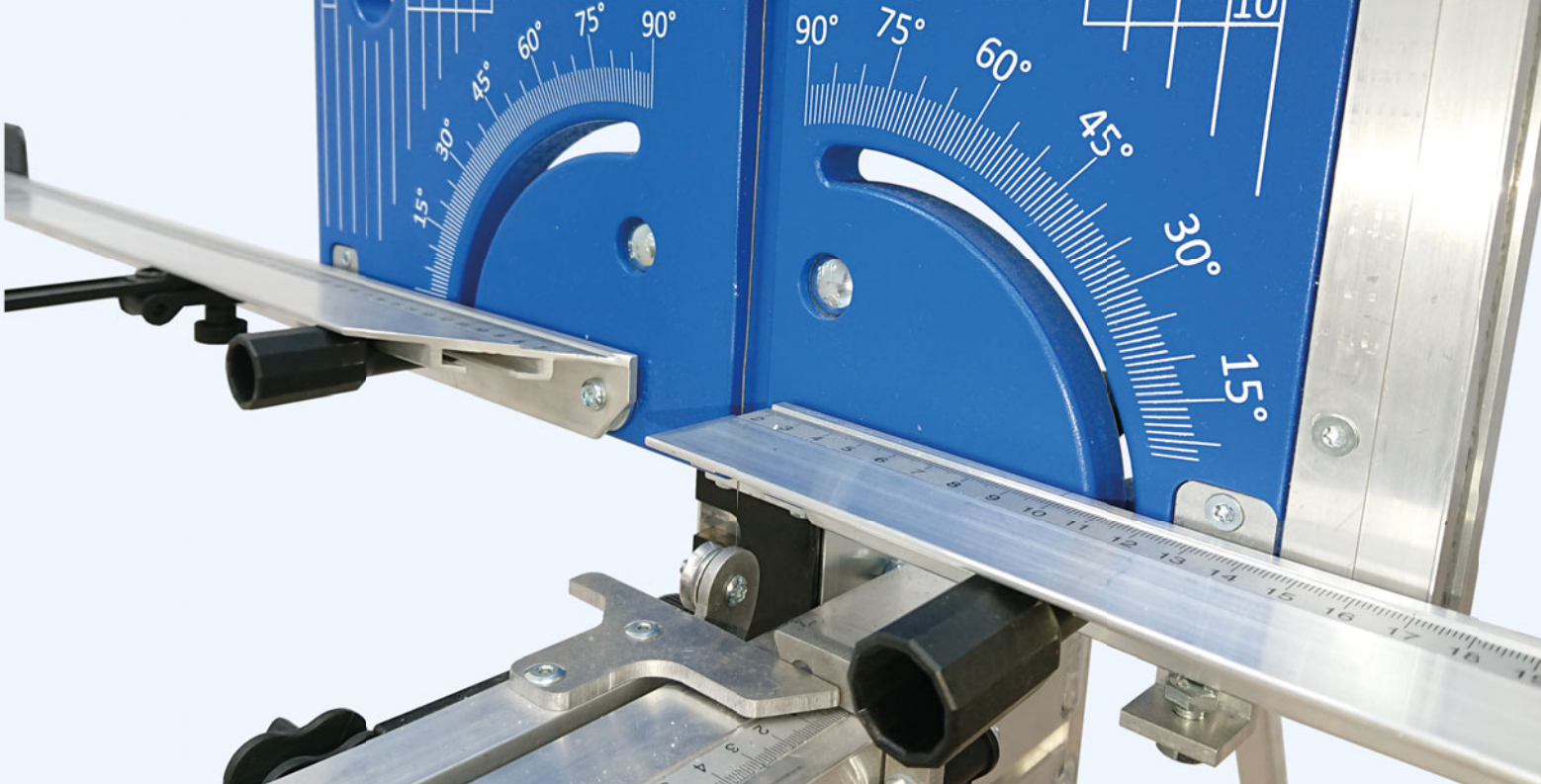

Accessories for SPEWE GT127-34

Included with the equipment

Corner cutter guide rail

Foldable longitudinal

Spare wire 9 m

Optionally available

Free-standing support

Corner cutter ES-GT127-34

Transport case



The product

Robust glow-wire floor-mounted cutting device SPEWE GT127-34 for polystyrene panels with adjustable bow cutter length and infinitely adjustable carriage for gradient cuts up to approx. 7°. Height-adjustable stand. Available also with battery.

Technical Data

- Cutting depth at 90°:	340 mm
- Cutting depth at 45°:	225 mm
- Cutting length:	770 - 1280 mm
- Weight:	17.9 kg

Delivery information

SPEWE GT127-34 cutting device, corner cutter guide rail, foldable longitudinal, spare wire

Dosteba AG

CH-8184 Bachenbülach

Phone: +41 43 277 66 00

Dosteba GmbH

D-72770 Reutlingen

Phone: +49 7121 30177 10

