

Always a
cut ahead!



All-purpose cutting device SPEWE 1900ML-30



Dosteba

*Werkzeuge sind
Tools are
unsere Stärke
our strength*

SPEWE 1900ML-30

Convincing details

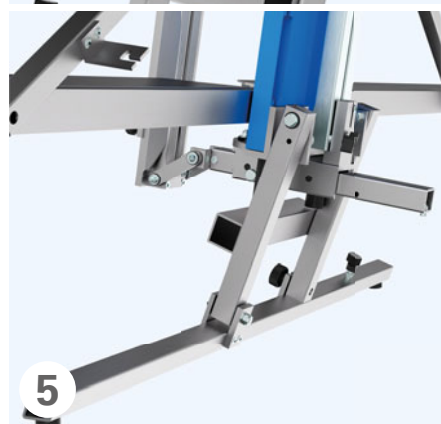
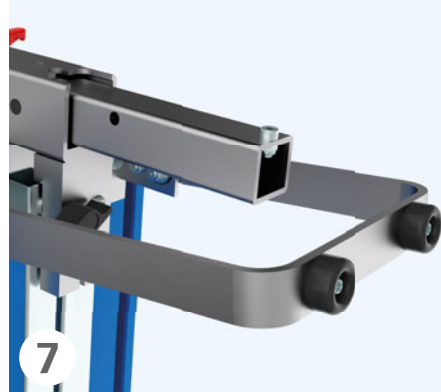

Types of cuts

straight

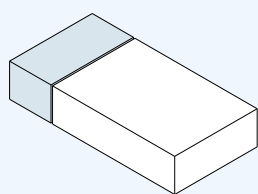

mitre

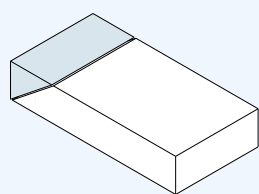

bevel

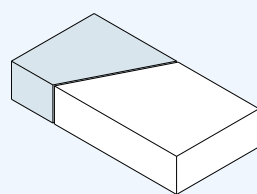

bevel with mitre

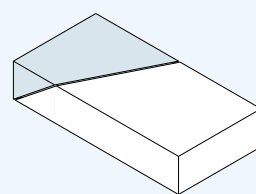

All-purpose cutting device

Installation positions



10



- 1 Preset values set to insulation thickness with locking mechanism (9–13 cm / 13–17 cm / 16–20 cm / 20–24 cm / 23–27 cm / 27–31 cm)
- 2 Short-stroke parallelogram for user-friendly clamping of cutting material
- 3 Cutting tool guided on both sides. The clearance of the rear guide rails can be precisely adapted to the width of the cutting tool
- 4 Swivel-mounted cutting guide from -5° to $+45^{\circ}$ with latching at 90°
- 5 Integrated double-hinged foot with extra long tread for improved equipment even with heavy plates
- 6 Double-sided large swivel-mounted plate bearings for precise and individual bevel cuts
- 7 Wall support enables working on scaffolding without a free-standing support
- 8 Matching cutting guides with spring-loaded pawl to attach selected brand sawing machines and reciprocating saws
- 9 For use with optional sawing machine (DeWalt or Bosch) or optional sabre saw (Bosch Battery, Milwaukee Battery)
- 10 Stand-alone unit with optional roller and plate stands as support and for guiding heavy insulation panels
- 11 Stand-alone unit with optional roller and plate stands for efficient processing of rolls of insulation felt



Accessories for SPEWE 1900ML-30

Included with the equipment

Telescopic free-standing support

Cutting guides for selected sabre saws

Open-end wrench M5/M6



Optionally available

Cut reduction for plate thicknesses of 10 to 100 mm

Saw guide for cuts with circular handsaws

Roller and plate stand



The product

All-purpose cutting device SPEWE 1900ML-30 for electrical cuts. Suitable for stone and glass-wool plates, cellular glass, fibreboard plates, ecological insulation material, cork, polyisocyanurate (PIR), polyurethane (PUR), sandwich panels etc. Quick start-up is guaranteed as all parts are mounted on the device. Can also be used on the scaffold thanks to low construction height (only 185 cm). Variety of extensions.

Technical Data

- Cutting depth at 90°: 100 - 305 mm
- Cutting depth at 45°: 100 - 180 mm
- Cutting length: 1270 mm
- Weight: 24 kg

Delivery information

SPEWE 1900ML-30 cutting device, with telescopic free-standing support, swivel-mounted guide arms on the side, cutting guides, open-end wrench M5/M6

Dosteba AG

CH-8184 Bachenbülach
Phone: +41 43 277 66 00

Dosteba GmbH

D-72770 Reutlingen
Phone: +49 7121 30177 10

